

SWATYCOMET CENTERLESS-CR

Resin bonded grinding wheels

These grinding wheels are used for the mass production roughing and finishing of cylindrical shape workpieces.



**Grinding wheels
in resin bond for
through-feed
centerless.**



**NEW GENERATION
PRODUCTS**

SWATYCOMET

CENTERLESS-CR

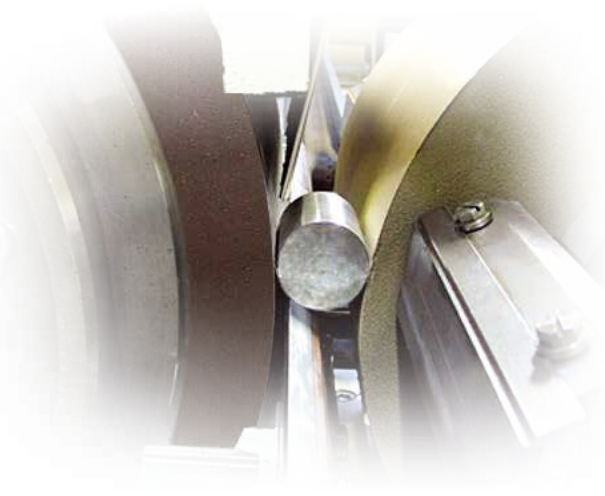

Features:

- faster material removal
- good surface quality after fine grinding
- achieving high-accuracy roundness and cylindricity of the workpiece and good dimension accuracy
- good profile holding capability and long lifetime of the wheel
- grinding application from rough, medium to fine grinding.



1

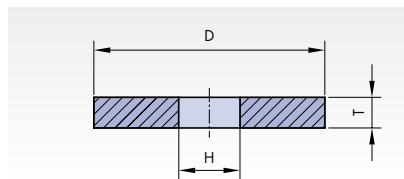

7

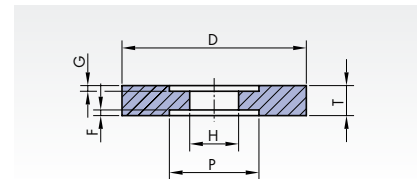

Shape	Specification	Dimensions (D x T x H) mm
1	57C70P8B	400 x 200 x 203,2
7	C150R8B23	500 x 250 x 254-355 x 25/25
1	9C70P8QR8B	600 x 250 x 355
1	9C36M6B05	600 x 250 x 355
1	57C46N6B	610 x 508 x 304,8

