

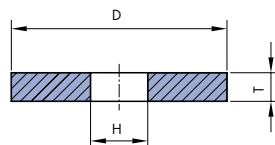

Brusne plošče 1

D x T x H



D	T	H
100	10 - 102	10, 13, 16, 20, 25, 32
125	10 - 102	13, 16, 20, 25, 32, 40
150	10 - 152	13, 16, 20, 25, 32, 40
200	10 - 152	13, 16, 20, 25, 32, 40, 50.8
225	10 - 152	16, 20, 25, 32, 40, 50, 60
250	10 - 152	20, 25, 32, 40, 50.8, 76.2
300	10 - 152	32, 40, 50.8, 76.2, 127
350	10 - 152	32, 40, 50.8, 76.2, 127, 152.4
400	10 - 203	40, 50.8, 76.2, 127, 152.4, 203
450	10 - 254	76.2, 127, 152.4, 203, 254, 305
500	20 - 254	127, 152.4, 203, 254, 305
600	20 - 254	127, 152.4, 203, 305

Brusne plošče 5

D x T x H - P x F

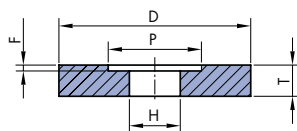

D	T	H	P	F
100	10 - 102	16, 20, 25, 32, 40	60	F = max. T/2
125	10 - 102	25, 32, 40, 50.8	75	
150	10 - 152	25, 32, 40, 50.8	75	
200	10 - 152	25, 32, 40, 50.8	110	
225	10 - 152	25, 32, 40, 50.8	110	
250	10 - 152	32, 40, 50.8, 76.2, 100	130	
300	10 - 152	32, 40, 50.8, 76.2, 127	190	
350	10 - 152	76.2, 127, 152.4	215	
400	10 - 203	127, 152.4, 203	230	
450	10 - 254	127, 203, 254, 305	290	
500	20 - 254	152.4, 203, 305	290	
600	20 - 254	152.4, 203, 305	290	

Primer za izpis naročila:
5 300x50x127-190x20
2A60 J7V

Po posebnem naročilu lahko izdelamo tudi bruse drugih dimenzij.

**Brusne plošče 7**

D x T x H - P x F / G

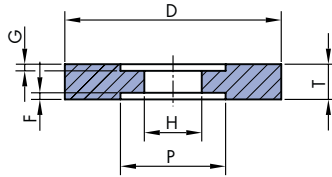

D	T	H	P	F,G
100	10 - 102	16, 20, 25, 32, 40	60	F+G = max. T/2
125	10 - 102	25, 32, 40, 50.8	75	
150	10 - 152	25, 32, 40, 50.8	75	
200	10 - 152	25, 32, 40, 50.8	110	
225	10 - 152	25, 32, 40, 50.8	110	
250	10 - 152	32, 40, 50.8, 76.2, 100	130	
300	10 - 152	32, 40, 50.8, 76.2, 127	190	
350	10 - 152	76.2, 127, 152.4	215	
400	10 - 203	127, 152.4, 203	230	
450	10 - 203	127, 203, 254, 305	290	
500	20 - 254	152.4, 203, 305	290	
600	20 - 254	152.4, 203, 305	290	

SPLOŠNA PRIPOROČILA

POGONSKE PLOŠČE

Keramično vezane	A80QV
Smolno vezane	3A80-100 T7B

**Obdelovalni material:****Jekla:**

- Univerzalna večnamenska
- Nekaljena jekla
- Kaljena do 62 HRc
- Kaljena nad 62 HRc
- Hitrorezna (HSS)
- Nerjavna avstenitna martenzitna

**Trdine:**

- Karbidne trdine

**Litine:**

- Siva litina
- Nodularna
- Jeklana

**Barvne kovine:**

- Al in zlitine
- Cu in zlitine

**Nekovine:**

- Plastične mase
- Guma

Kakovostni nivo/Gradivo

	STANDARD	EXTRA	SUPERABRAZIV
Jekla:			
- Univerzalna večnamenska			
- Nekaljena jekla	4A 60 K7V		
- Kaljena do 62 HRc	2A80 J8V	3LA80 J8V	
- Kaljena nad 62 HRc	8A60 I7V		03B91N5V
- Hitrorezna (HSS)	8A60 I7V		03B91N5V
- Nerjavna avstenitna martenzitna	C80 I8V		
	2A80 I8V		
Trdine:			
- Karbidne trdine	C80 I8V		01D126P4V
Litine:			
- Siva litina	C46 I6V, C60 J7V		
- Nodularna	9C46 I6V, 9C60 J7V		
- Jeklana	52A36 J6V, 2A80 J8V		
Barvne kovine:			
- Al in zlitine	9C46H10/3V		
- Cu in zlitine	9C46H10/3V		
Nekovine:			
- Plastične mase	9C46 H12V, 2A36 FG13/1V		
- Guma	9C46 G13V, 2A46 I13/2V		

Za centerless brušenje v napadu, uporabi 2 stopnji finejšo granulacijo.