

Brusne plošče 1

D x T x H

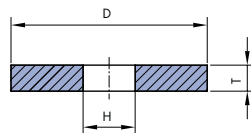

D	T	H
100	10 - 102	10, 13, 16, 20, 25, 32
125	10 - 102	13, 16, 20, 25, 32, 40
150	10 - 152	13, 16, 20, 25, 32, 40
200	10 - 152	13, 16, 20, 25, 32, 40, 51
225	10 - 152	16, 20, 25, 32, 40, 50, 60
250	10 - 152	20, 25, 32, 40, 51, 76
300	10 - 152	32, 40, 51, 76, 127
350	10 - 152	32, 40, 51, 76, 127, 152.4
400	10 - 203	40, 51, 76, 127, 152.4, 203
450	10 - 254	76, 127, 152.4, 203, 254, 305
500	20 - 254	127, 152.4, 203, 254, 305
600	20 - 254	127, 152.4, 203, 305

CBN-V Brusne plošče 1A1

D x T x X x H

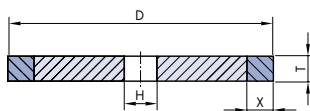

D	T	X	H
200	10	5	32, 50
250	20	5	50, 76.2, 127
300	20	5	76.2, 127
350	20	5	76.2, 127
400	20	6	127, 203.2
500	20	6	127, 203.2

Primer za izpis naročila:

1A1 300x20x5x67.2

B126M6V



Brusne plošče 5

D x T x H - P x F

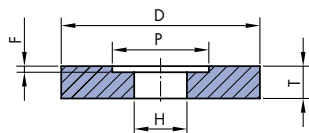

D	T	H	P	F
100	10 - 102	16, 20, 25, 32, 40	60	F = max. T/2
125	10 - 102	25, 32, 40, 51	75	
150	10 - 152	25, 32, 40, 51	75	
200	10 - 152	25, 32, 40, 51	110	
225	10 - 152	25, 32, 40, 51	110	
250	10 - 152	32, 40, 51, 76, 100	130	
300	10 - 152	32, 40, 51, 76, 127	190	
350	10 - 152	76, 127, 152,4	215	
400	10 - 203	127, 152,4, 203	230	
450	10 - 254	127, 203, 254, 305	290	
500	20 - 254	152,4, 203, 305	290	
600	20 - 254	152,4, 203, 305	290	

Brusne plošče 7

D x T x H - P x F / G

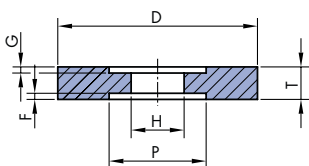





D	T	H	P	F,G
100	10 - 102	16, 20, 25, 32, 40	60	F+G = max. T/2
125	10 - 102	25, 32, 40, 51	75	
150	10 - 152	25, 32, 40, 51	75	
200	10 - 152	25, 32, 40, 51	110	
225	10 - 152	25, 32, 40, 51	110	
250	10 - 152	32, 40, 51, 76, 100	130	
300	10 - 152	32, 40, 51, 76, 127	190	
350	10 - 152	76, 127, 152,4	215	
400	10 - 203	127, 152,4, 203	230	
450	10 - 203	127, 203, 254, 305	290	
500	20 - 254	152,4, 203, 305	290	
600	20 - 254	152,4, 203, 305	290	

Primer za izpis naročila:
7 300x50x127-100x15/10
8 2A 46 G 12 V

Po posebnem naročilu lahko izdelamo tudi bruse drugih dimenzij.



	Kakovostni nivo/Gradivo	
	STANDARD	EXTRA
Področje uporabe:		
Univerzalno - večnamensko:		
 Nekaljena jekla	2A46JV	3GA46J6V
Kaljena jekla	82A46H12V	3GA46H12V
Specialno brušenje:		
Nekaljena jekla (jeklo za avtomate in konstrukcijsko jeklo)	2A46H8V	
Kaljena jekla (nizko legirana do 60HRc)		
- Poboljšana jekla	2A46H12V, 82A46H12V	3GA60G12V
 Kaljena jekla (visoko legirana nad 62HRc)		
- Orodna jekla	82A46H12V	3GA60F12V, B126M6V
- Hitroreznno jeklo (HSS)	8A60F12V, 18GA60F12V	3GA46F12V
Nerjavna jekla (INOX):		
- Nekaljena	4A60H12V, C60H12V	
- Kaljena	84A60G12V	
Jekla za nitriranje:		
- Termično neobdelano - jedro	82A46H8V	
- Nitirano	C60H12V, C60F12V (>62HRc)	
 Litine:		
- Jeklena litina	82A60H12V	
- Siva litina	C60H12V	
- Temprana in nodularna litina	82A60H12V	
 Karbidna trdina (HM) in keramika:	C60H12V	
 Nekovine in barvne kovine:		
- aluminij, baker, bron,...	2A46J8V, C46H12V	
- guma	2A36G12V, 1A24J7V	